

HOW TO DO THE RAPID TEST FOR SYPHILIS

Training in the use of **First Response Syphilis Anti-TP Card Test** for the Diagnosis of Syphilis in Human Whole blood/serum/plasma.

- a. New unopened test device pouch
- b. New unopened alcohol swab
- c. New unopened lancet
- d. New pair of disposable gloves
- e. Assay Buffer Bottle
- f. Timer
- g. Biohazardous waste container
- h. Non-biohazardous waste container
- i. Permanent Marker



Disposable gloves



Alcohol swab



Permanent CD Marker



Lancet



Timer



Assay Buffer Bottle

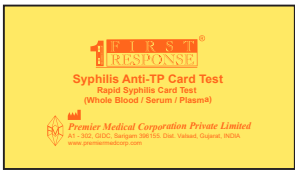

Test device pouch

READ THE INSTRUCTIONS CAREFULLY BEFORE PERFORMING THE TEST.

1. Check the expiration date of the test.

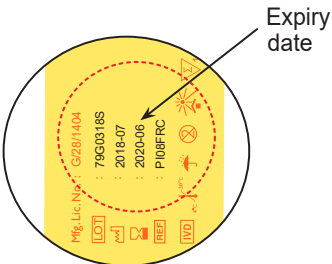

2. Put on gloves. Use new gloves for each patient.



3. Open the pouch and remove:

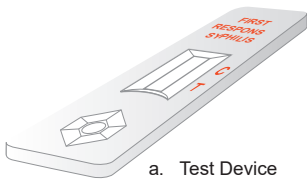

4. Label the test device with patient identification number/name



5. Wipe the complete fingertip with the alcohol swab provided and wait until the fingertip dried completely.

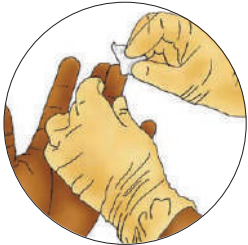

6. Detach the protective cap of the lancet. Squeeze the fingertip then prick the lateral side of the fingertip with sterile lancet provided.

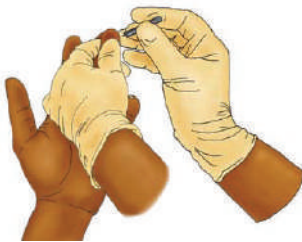

7. Dispose the lancet immediately into the sharps box.



8. Wipe the first drop of the blood using sterile gauze. Gently squeeze your fingertip once again to obtain a large second drop of blood (~40-50 µl). Take the specimen transfer device provided and hold it vertically. Gently squeeze the bulb of specimen transfer device and immerse open end in the center of a blood drop and release the bulb slowly to draw up the blood up to the 20 µl marking line on the specimen transfer device.



9. Hold the specimen transfer device vertically as shown in above figure and gently squeeze the bulb of specimen transfer device to dispense 20 µl of whole blood/serum/ plasma (Filled up to the marking) to the specimen well (s) by gently touching the tips of the specimen transfer device to the sample pad.

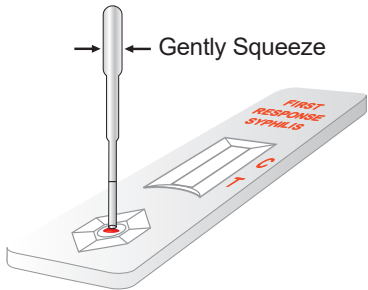

10. Dispose the used specimen transfer device into the biohazardous container.



11. Add two drops of assay buffer into the buffer well vertically.

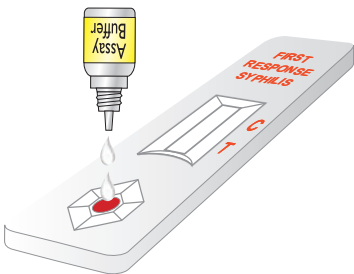

12. Read the test results at 20 minutes.

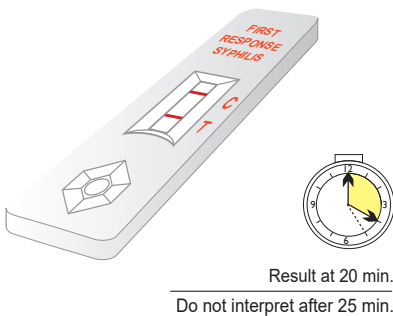

14. How to read the test results:

POSITIVE

A line in "C" & a line in "T" means the patient **DOES** have Syphilis Infection.

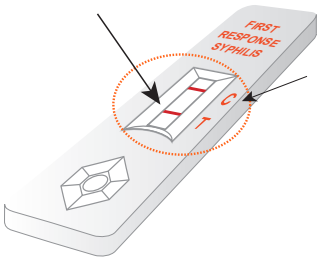

NEGATIVE

A line in "C" and NO LINE in "T" means the patient **DOES NOT** have Syphilis Infection.

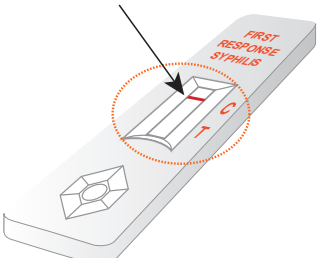

INVALID RESULT

No line in "C" & "T" means the test is **INVALID**

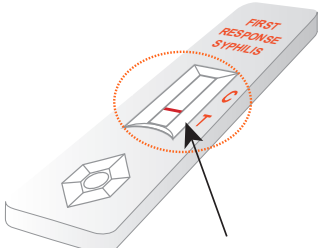
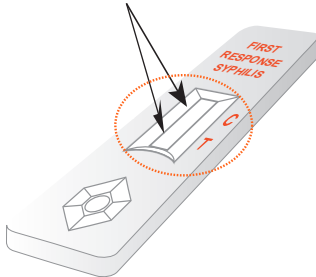

ONLY line in "T" means the test is **INVALID**

The Invalid test results should be retested with new test device.

15. Record the test results. Dispose of used test device into biohazardous waste container.



16. Dispose off desiccant and used gloves in a biohazardous waste container. Dispose off the packaging materials in a non-biohazardous waste container.



NOTE: Do not re-use the test device, alcohol swab, lancet and specimen transfer device as are intended for single use only



ISO 13485 & EN ISO 13485
Certified Company

Manufactured by



Premier Medical Corporation Private Limited

A1-302, GIDC, Sarigam 396155. Dist. Valsad, Gujarat, INDIA

• Customer support email : info@premiermedcorp.com • Tel.: +91 260 2780112/113, • www.premiermedcorp.com