

# JOB AID

For more detailed instructions please refer to Instructions for use.



## HCV Card Test (Self Test) (Whole Blood)



Training in the use of First Response® HCV Card Test (Self Test) that is intended to use for self-testing by untrained/lay user as an aid to detect antibodies specific to HCV in human whole blood.

Please read instructions for use completely, prior to use.

All components must be brought to room temperature (between 15-30°C) prior to testing.

**Caution:**  
**DO NOT USE THE TEST DEVICE AND ANY COMPONENTS MORE THAN ONCE.**

Materials Provided  
• Each self test pack contents:  
Test device with desiccant & Specimen transfer device,  
Alcohol swab, Dry swab, Bandage, Sterile lancet,  
Assay buffer vial, Instructions for use, Biohazard bag.

Materials required but not provided:  
Clock, watch or timing device

### HOW TO USE THE FIRST RESPONSE® HCV CARD TEST (SELF TEST)

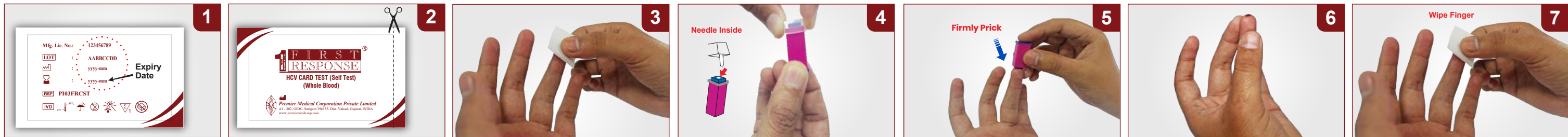

Before starting the test procedure, wash your hands, preferably with warm water and soap, and dry them completely before testing.  
Check the expiry date of test device.

Open the test device pouch by tearing along the notch and verify the pouch contents.

Wipe your fingertip (Choose Middle or Ring finger) by using the alcohol swab and allow it to dry for approximately 15 seconds.

Carefully remove the clear protective cap of the sterile safety lancet provided.

Place the uncapped lancet over the cleaned fingertip and press down firmly to prick your skin with the needle.

Gently squeeze your fingertip to obtain a large first drop of blood.

Wipe the first drop of the blood away using dry swab provided.

⚠ It only pricks once!

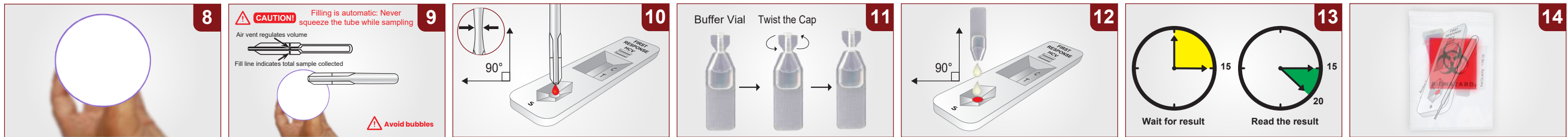

Without pressing too hard, gently squeeze your fingertip once again to obtain a large second drop of blood.

Hold the tube horizontally, and touch the tip of specimen transfer device to the blood. Capillary action will automatically draw the blood to the fill line (35µl) and stop.

⚠ **Note:** Perform the testing immediately after collection of specimen.

Place the test device on a flat, clean and dry surface. Transfer whole blood collected in specimen transfer device into sample well (S) by touching the bottom of the sample well (S) as shown in above figure.  
*Note: If sample won't expel, you probably didn't allow the tube to fill all the way. Touch the tip to the blood sample again and allow it to fill completely. Then align the tip with the sample well and squeeze the bulb.*

Take the assay buffer vial provided & twist the cap to open single use assay buffer vial as shown in above figure.

Gently press the single use assay buffer vial to add 2 drops of assay buffer to the sample well (S). Wait for 15 minutes. Meanwhile, apply bandage to the finger.

Read the test result at 15 minutes. Do not interpret after 20 minutes.

After reading test result dispose of all used kit contents into the Disposal bag provided and throw away in waste bin or house hold rubbish bin.

⚠ Blood can transmit infectious diseases. Clean up spills. Dispose in accordance to local regulations

### RESULT, INTERPRETATION AND FOLLOW UP



#### Read test result in a well-lit area

#### Non-reactive (Negative) result

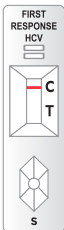

If only one color line appears at control line 'C' as in the figure, the specimen is non-reactive (negative).

**Follow Up:** Seek regular testing. If you may have been exposed to HCV, repeat the test again in 3 months.

#### Reactive (Positive) result

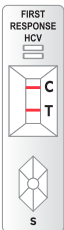

If two color lines appear, one at control line 'C' and the other at test line 'T' as in the figure you may be HCV positive and should seek additional testing and medical care.



**Consult a health care provider.**  
A reactive result must be confirmed by a lab test. Protect yourself and others! Avoid any activity that could transmit HCV to others.



**Follow Up:** As soon as possible, visit your nearest HCV Testing Center or Health Facility.

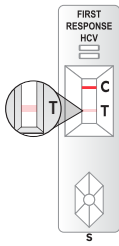

Presence of faint line at test line 'T' as shown in figure you may be HCV positive and should seek additional testing and medical care.

#### Invalid result

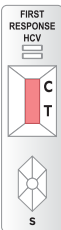

No presence of control line 'C' in the result window (irrespective of presence of test lines) or a red background makes it impossible to read the test results indicates an invalid result. The directions may not have been followed correctly and should be retested with new test device.

**Follow Up:** If the test did not work properly. You must repeat the test or visit your nearest HCV testing center or health facility.



Manufactured by  
**Premier Medical Corporation Private Limited**  
A1-302, GIDC, Sarigam-396155, Dist. Valsad, Gujarat, INDIA.  
Customer support email: info@premiermedcorp.com  
Tel: +91 260 2780112/113, www.premiermedcorp.com



ISO 13485 & EN ISO 13485  
Certified Company