

HOW TO PERFORM RAPID TEST FOR MALARIA

Training for the use of First Response® Malaria Ag. *P.falciparum* (HRP2/pLDH) Card Test for differential diagnosis of *P. falciparum* specific to pLDH &/or HRP2

- New unopened test device pouch
- New unopened alcohol swab
- New unopened lancet
- New pair of disposable gloves
- Assay Buffer Vial
- Timer
- Biohazard waste container
- Non-biohazard waste container
- Permanent Marker



Disposable gloves



Alcohol swab



Permanent Marker



Specimen Transfer Device



Lancet



Timer



Assay Buffer Vial



Test device pouch

READ THE INSTRUCTIONS CAREFULLY BEFORE PERFORMING THE TEST.

1. Check expiry date on the test pouch.
(If expired, do not use)

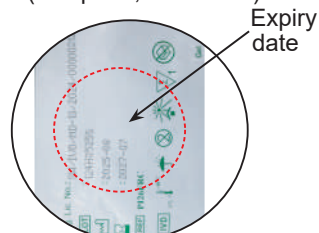

2. Put on gloves. Use new gloves for each patient.



3. Open the pouch and remove:

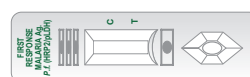

a. Test Device

b. Desiccant

Desiccant Validity
Orange: Valid
Green: (Do not use the test device if the desiccant turns green).

4. Label the test device with patient identification number/name



5. Wipe the patient finger with alcohol swab.
(Alcohol must be dry before pricking)

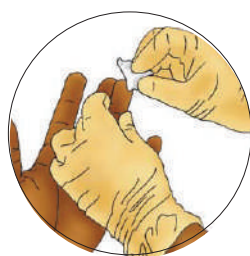

6. Take the lancet and detach the cap of the lancet and pierce the finger with the lancet.



7. Dispose the lancet immediately into the sharps box.



8. Take the specimen transfer device and collect 5 µl of blood by touching the circular end of the specimen transfer device into the blood drop.



9. Touch the specimen transfer device into the specimen well vertically.

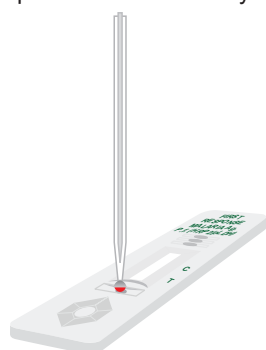

10. Dispose the used specimen transfer device into the biohazardous container.



11. Add two drops of assay buffer into the buffer well vertically.

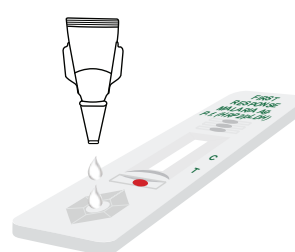

12. Interpret the result at 20 minutes.



13. Do not Interpret after 30 minutes.

14. How to interpret test results.

NEGATIVE

If only one color line appear, at control line 'C' as in the figure, the specimen is negative.

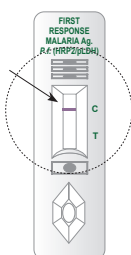

POSITIVE

If two color lines appears, one at control line 'C' and other at test line 'T' as in the figure, the specimen is reactive for HRP2 &/or pLDH antigens of *P. falciparum*. Interpret faint line as reactive line.

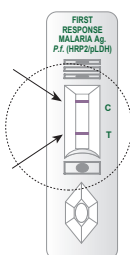

INVALID RESULT

No presence of control line 'C' in the result window (irrespective of presence of test line) indicates an invalid result.

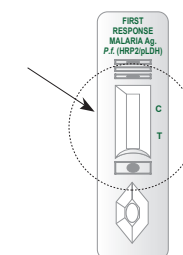
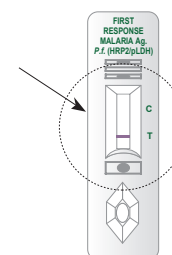

The invalid test results should be retested with new test device.

15. Record the test results. Dispose of used test device into biohazard waste container.



16. Dispose off desiccant and used gloves in a biohazardous waste container. Dispose off the packaging materials in a non-biohazard waste container.



NOTE: Do not re-use the test device, alcohol swab, lancet and specimen transfer device as are intended for single use only

Manufactured by

Premier Medical Corporation Private Limited

A1-302 and 3704-05, GIDC Sarigam, Valsad, Gujarat (India) - 396155

• Customer support email : info@premiermedcorp.com • Tel.: +91 260 2780112/113, www.premiermedcorp.com



ISO 13485 & EN ISO 13485
Certified Company