

HIV 1-2.0 CARD TEST (Version 2.0)

Whole blood / Serum / Plasma
Rapid HIV Card Test

FEATURES

- ▶ Clear background
- ▶ Self contained test procedure
- ▶ Specifically engineered for whole blood specimen , as well as serum & plasma
- ▶ Clear differentiation between HIV1 and HIV 2 infections
- ▶ Detects antibodies to gp41 & gp36
- ▶ Storage temperature 4°C - 30°C & long shelf life up to 24 Months

BENEFITS

- ▶ Unmistakable results at 15 minutes.
- ▶ Simple and easy to use, does not require advanced medical training.
- ▶ Cost effective, can be used effectively in resource-limited conditions.
- ▶ Accurate and reliable.
- ▶ Helps to detects separately for HIV-1 and HIV-2.
- ▶ Sensitive and accurate with the most known subgroups and early seroconversion samples.
- ▶ Does not require cold chain & convenient for small volume users.

EXTERNAL LABORATORY EVALUATION REPORTS

Name of the Institute	Year of Testing	Sensitivity	Specificity
WHO PQ Evaluation	2018	100 %	100 %
Ghana Health Care Service, Ghana (Whole blood specimens)	2018	100 %	100 %
Virus Research Institute, Uganda	2018	100 %	100 %
Ministry of Health and Child Care, Zimbabwe (Pregnant women whole blood specimen)	2019	100 %	100 %
National Institute for Communicable Diseases, South Africa	2019	100 %	100 %

KIT CONTENTS

- Test device with desiccant
- Assay buffer bottle
- Specimen transfer device
- Sterile lancet
- Alcohol swab
- Instructions for use

TEST PROCEDURE

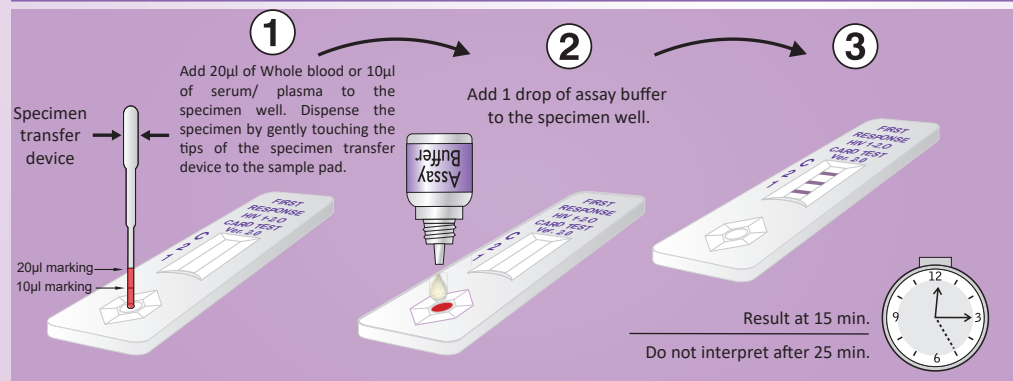

RESULTS INTERPRETATION

Negative	HIV-1 Positive	HIV-2 Positive	HIV-1 & 2 Positive	Invalid Results

ORDERING INFORMATION

Info@premiermedcorp.com

Type : Bulk Packing

Catalogue No.	Pack Size
PI05FRC05	05 Tests / Kit
PI05FRC25	25 Tests / Kit
PI05FRC30	30 Tests / Kit
PI05FRC50	50 Tests / Kit
PI05FRC100	100 Tests / Kit
PI05FRC25CE	25 Tests / Kit
PI05FRC30CE	30 Tests / Kit



ISO 13485 & EN ISO 13485 Certified Company

Part No. : PI05-BRO-001, Rev.AF, Date: 2021-05-04



Manufactured by

Premier Medical Corporation Private Limited

Mfg. Unit : A1-302, GIDC, Sarigam 396155. Dist. Valsad, Gujarat, INDIA

• Customer support email : info@premiermedcorp.com • Tel. : +91 260 2780112/113, • www.premiermedcorp.com